

## Class Read

## The Boy who Grew Dragons

## R.E.

Galilee to JerusalemHear

Retell the visit of the Magi and explain what the visit of the Magi and the gifts they bring show us about Jesus.

Begin to recognise that the miracles of Jesus are signs that he is the Son of God.

Show knowledge of two parables of Jesus, making links between them.

Believe

Show a simple understanding of what the kingdom of God is and is not.

Celebrate

Recall the 'Our Father' prayer and make simple links between the prayer and building the kingdom.

## English



## Mia and the Giant— Fiction

Use features of the Toolkit in my writing:

Openings and Endings

Use time— *Late one night*

Weather— *snow fell*

Start with the name of the character— *Bill stared out of the window.*

Think about how the character feels and show this at the start— *Bill glared at his teacher.*

Use dramatic speech— *"How do we escape now?"*

Start with questions or exclamations to hook the readers interest— *"Run!" they yelled.*

Characterisation

Use a name to suggest the character— *Mr Hardy* (strong and tough) *Miss Honey* (gentle)

Show how a character is feeling through their actions and reactions— *Sarah glowered; a shiver shot up her spine.*

Give your main character a hobby, interest or special talent:

*Shiv kept a pet rat called Simon in a cage made of bamboo shoots.*

## Science

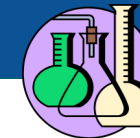
Animals, including humans

Identify that animals, including humans, need the right types and amount of nutrition, and that they cannot make their own food — they get nutrition from what they eat.

Identify that humans and some other animals have skeletons and muscles for support, protection and movement.

## Mathematics

Multiplication and Division

Multiplication— equal groups

Use arrays

Multiples of 2

Multiples of 5 and 10

Sharing and grouping

Multiply by 3, divide by 3

Multiply by 4, divide by 4

Multiply by 8, divide by 8

2, 4 and 8 times table



## Shared Reading

## The Wolf's Secret

## Art

L.S. Lowry

Who was Lowry?

Look at examples and describe how Lowry would quickly draw his initial sketches.

Describe the typical features of Lowry's matchstick people.

Techniques Lowry used to create tones.

Knowing why Lowry's colour palette was so restricted.

Creating a painting showing workers in an industrial town.

## Geography

UK

Comparing the countries of the UK.

The UK's major cities.

Physical characteristics of the UK.

The UK's landscape and people.

Industries in the UK.

## Personal Social and Relationship Education

Online Safety

Online relationships— explain how someone's feeling can be hurt by what is said online.

Importance of giving and gaining permission before sharing online.

Online Reputation— Being careful about what we share online.

Explaining who someone can ask if they are unsure about putting something online.

## Computing



Document editing and creation

3D design.

Human processes

## Music

Pentatonic Scales / Human Body

Play a 'pentatonic' scale

Play melodies using the notes of the pentatonic scale

Write a pentatonic melody using letter notation

Play my pentatonic melody from letter notation

Perform a group composition made up of three-layer pentatonic melodies

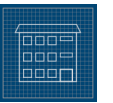

## Spanish



Recognise, recall and remember the 4 seasons in Spanish.

Recognise, recall and remember a short phrase for each season in Spanish.

Say which season is their favourite in Spanish and attempt to say why using the conjunctions 'y' and 'porque'.

## PE

Invasion Games— Football

Dribbling      Throwing

Passing      Teamwork

